

3 mm Thick EDPM Rubbers To Clamp 10 mm Thick Glass Between Brackets

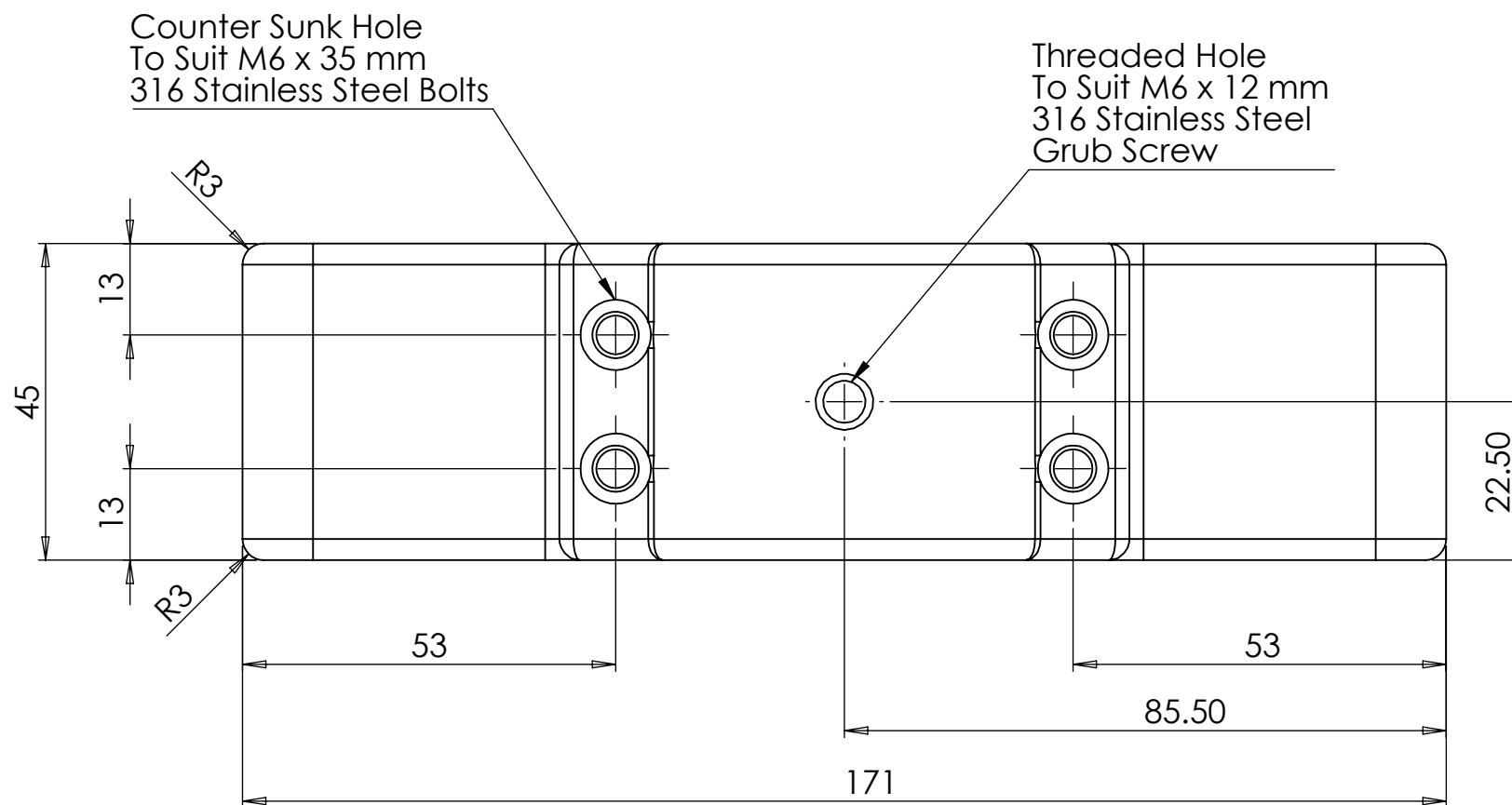

Note: All Fixings To Be Supplied With Brackets

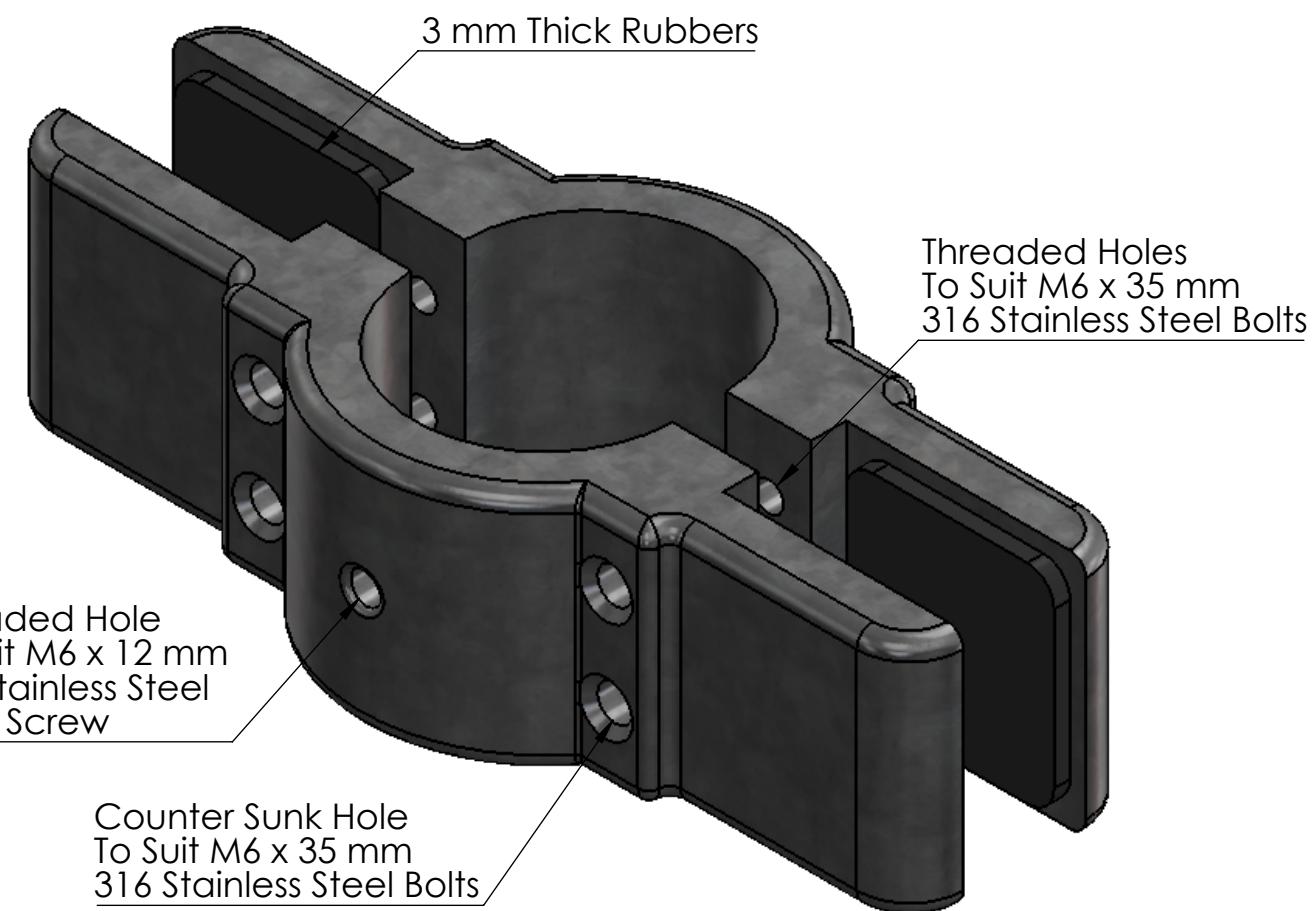

F.H.Brundle
Business First Centre, Empire Way
Burnley, BB12 6HH
Tel: 01282 834545, Fax: 0844 854 6724
E.mail: designs@brundle.com
Web: www.fhbrundle.co.uk

NOTES:
DEBUR AND REMOVE SHARP EDGES

TITLE:
Double 48.3 mm Budget Glass Clamp

PART NO:

DWG NO:
0080-010-01

A3

UNLESS OTHERWISE SPECIFIED ALL DIMENSIONS ARE IN MILLIMETERS

	NAME	DATE	REVISION	MATERIAL:
DRAWN	EF	12/09/2014	E	MALLEABLE IRON
REV. BY				FINISH:
				GALVANISED
				WEIGHT: 1.46 Kg

SCALE:1:1 DO NOT SCALE DRAWING SHEET 1 OF 1