

PIN NOT INCLUDED

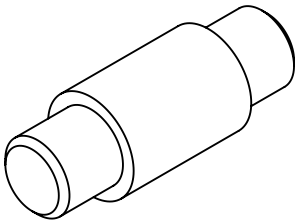

IF USING GLASS CLAMPS IN ANY INSTALLATION WHERE THE GLASS IS FIXED TO THE OUTSIDE OF A STAIRCASE AND OVERHANGING, THEN SECURITY PINS 189900401 OR 189900402 AND DRILLED GLASS MUST BE USED

PART CODE	MATERIAL	GLASS SIZE (T)	FINISH
1806400F06	AISI 316	6mm	Polished
1806400F	AISI 316	8mm	Polished

DESCRIPTION: Round Flat Back Glass Clamp - 6/8mm Glass Stainless 316 Satin Finish

	NAME	DATE	REVISION	UNLESS OTHERWISE SPECIFIED ALL DIMENSIONS ARE IN MILLIMETERS	
DRAWN	TS	19/04/2022	A		
CHECKED				DO NOT SCALE DRAWING	SCALE:2:1